

**Generator set
Sound-proof type
PR440P-SAE**

SPECIFICATIONS

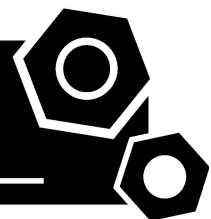

www.prpower.com | 1300 399 499

PR Power reserves the right to make changes in model, technical specification, color, configuration and accessories without prior notice. Please contact the sales team before ordering.

Rev. [July].[2023]

**Perkins series
PR440P-SAE**

50 Hz @ 1500rpm, 3-phase/5-wiring



1 Standards & Conditions

Design Standards

The designs and the productions are in conformity with:

- Conformance Européenne (CE)
- ISO8528-5:2005
- AS 3000-2018
- AS 3010-2017

Environmental Operating Conditions

- Installation place: Outdoors or indoors (well ventilated).
- Ambient temperature: -25°C to 50°C. The coolant heater is needed when the temperature is below 5°C
- Humidity: Less than 90%.
- Altitude: Below one thousand (1000) meters above sea level.

Factory Inspection

- Inspection items.
- Protection devices working test.
- Starting ability in normal temperature.
- 50% rated power load moment capability.
- Voltage deviation and speed variation: 0%, 25%, 50%, 75%, 100%, 110% Load.

Painting Process

- Painting process specifications and colors are based on the manufacturer's standard.
- The customer could also choose the color which the manufacturer offers.

2 General Features

- Perkins engine 2206C-E13TAG3
- Close coupled to Leroy Somer alternator LSA47.3S4
- Microprocessor controller ComAp InteliLite4-AMF9
- ABB main circuit breaker: 630A
- Rotate speed governor: Electronic
- Excitation System: Self Excited, SHUNT
- A.V.R. Model: R250
- Key switch
- Emergency stop switch
- ATS (automatic transfer switch) receptacle

- Remote run connector
- 2x12V/120AH sealed for life maintenance free battery
- Lockable battery isolator switch
- Powder coated canopy
- 50°C radiator
- Oil pump on the engine
- Non-returning valve for fuel inlet hose of the engine
- Steel base frame with forklifts
- Vibration isolators between the engine/alternator and base frame
- Dry type air filter
- Base fuel tank for 19 hours running
- Drain points for fuel tank
- Breather valve for fuel tank
- Operation Manual / Specifications

3 Equipment Specification

General technical data

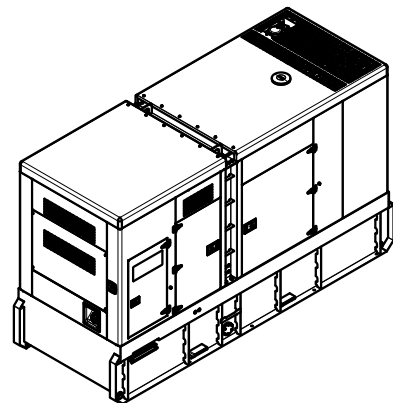

Model..... PR440P-SAE
 Structure type R
 Tank capacity..... 1650L
 Dry weight..... 4784kg
 Noise level @7m 74.9dBA
 Dimensions L×W×H..... 4242×1614×2476mm
 Standby Power 440kVA/352kW
 Prime Power 400kVA/320kW
 Voltage/Current..... 415V/556A

Genset Fuel Consumption					
Frequency/Load	25%	50%	75%	100%	110%
50Hz (L/h)	N/A	46	65	85	93

Diesel engine

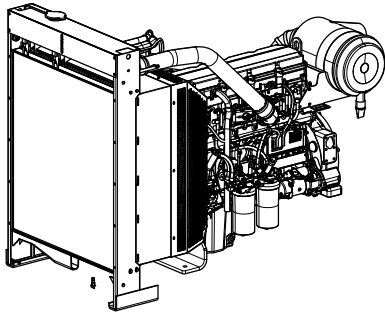

Engine Manufacturer/Brand.....	Perkins
Engine Model.....	2206C-E13TAG3
Dimensions L×W×H.....	2410×1120×1725mm
Dry Weigh (approx.)	1478Kg
Number of Cylinders.....	6
Bore	130mm
Stroke	157mm
Displacement.....	12.5L
Compression Ratio	16.3
Type of injection.....	Direct injection
Intake System.....	Turbocharged, air-to-air charge cooled
Intake Resistance	6.4kPa
Cooling System	Water cooled
Fan	Pusher
Battery Voltage	24V
Type of Fuel.....	BSEN590 or ASTM D975 Class 1D and 2D
Type of Oil	15W40 to API CI4.
Oil Capacity	40L
Type of Coolant	Glycol mixture
Coolant Capacity	51.4L
Back Pressure	N/A
Standby Power	413kW
Prime Power	368kW
Fuel Consumption(100%load).....	85L/h

Alternator

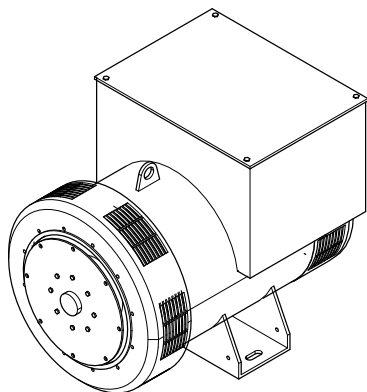

Alternator Manufacturer/Brand	Leroy Somer
Alternator Model	LSA47.3S4
Exciter.....	Brushless
Cooling Fan	Cast alloy aluminum
Windings.....	100% copper
Insulation Class	H
Winding Pitch.....	2/3
Terminals	12
Drip Proof	IP23
Altitude.....	≤1000m
Overspeed	2250rpm
Air Flow.....	0.9m³/s(50Hz), 1.1m³/s(60Hz)
Voltage Regulation	±0.5%
Total harmonic TGH / THCat no load < 1,5 % - on load < 2 %	
Telephone Interference.....	THF<2%; TIF<50

IntelliLite4-AMF9 Control System

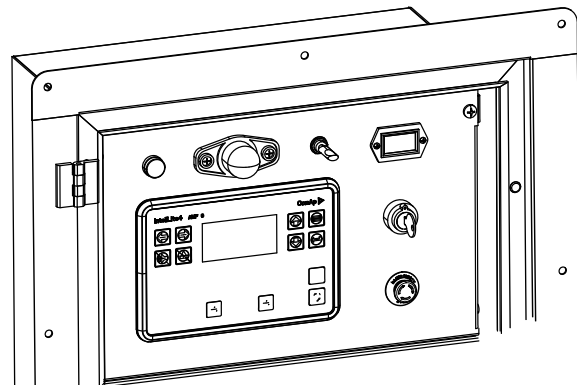

IntelliLite4-AMF9 is Single Gen-set controller for stand-by and prime-power applications and all-in-one intuitive & powerful PC tool for configuration/monitoring/control, locally or remotely and easy to install, configure and use

Standard Control Function

- Stand-by and prime-power application in one unit
- Dual Mutual Standby application support
- Remote display
- User setpoints and protections
- User Access Management
- Cyber security improvement
- Alternative configurations
- Multi-purpose schedulers

4 Overall Dimensions

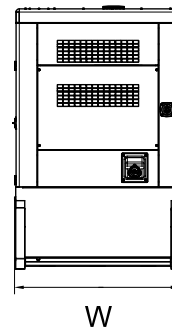
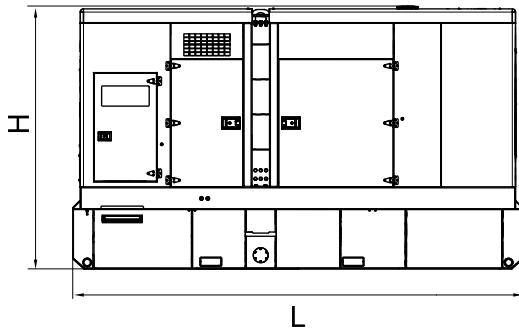
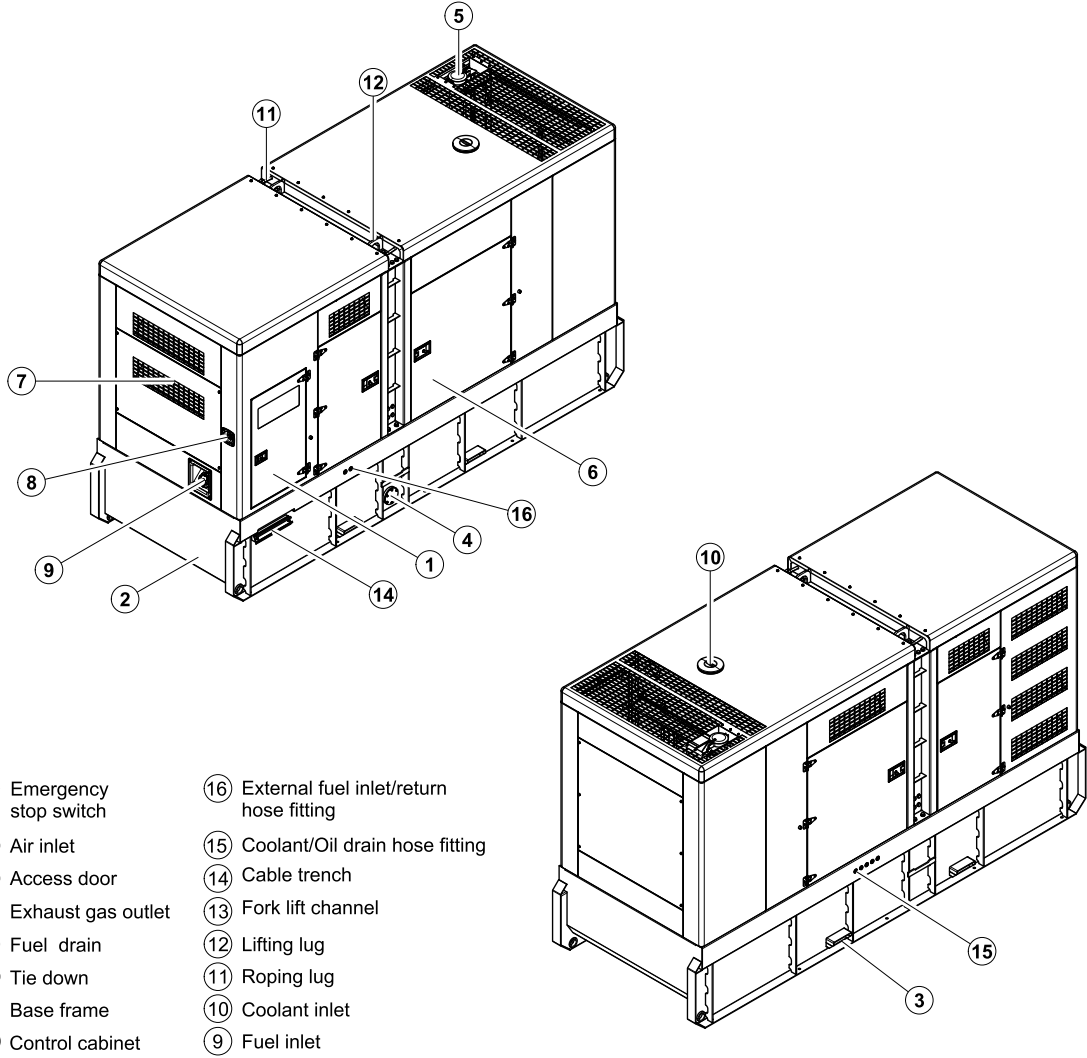

5 Control System

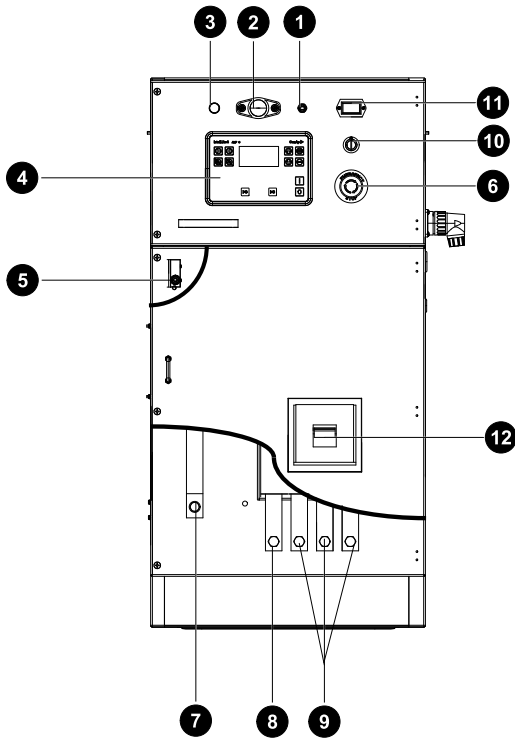

Control & field wiring cabinet

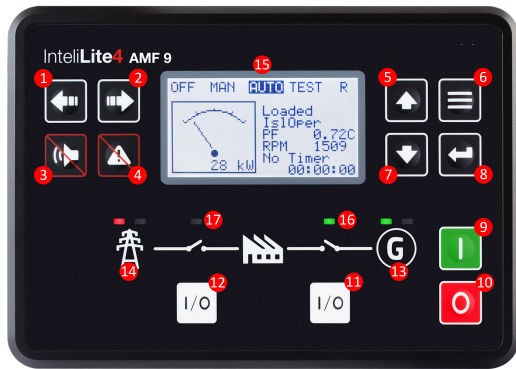

Control module

Ref.	Description
1	Control cabinet lamp switch
2	Control cabinet lamp
3	Charge indicator
4	Control module
5	Limit switch
6	Emergency stop button
7	Ground wire terminal
8	Neutral wire terminal
9	Live wire terminals
10	Key switch
11	Time counter
12	Main circuit breaker

Ref.	Description
1	LEFT button.
2	RIGHT button
3	HORN RESET button
4	FAULT RESET button
5	UP button
6	PAGE button
7	DOWN button
8	ENTER button
9	START button
10	STOP button
11	GCB button
12	MCB button
13	GENERATOR status indicator
14	MAINS status indicator
15	Graphic B/W display, 132 × 64 px.
16	GCB Status
17	MCB Status